

## ML414R

### Dimensions (mm)

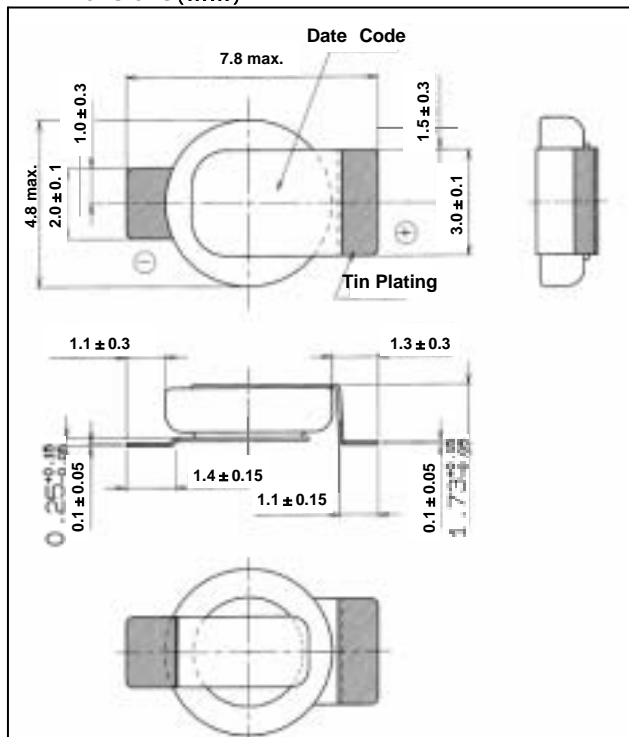

### Specification

Nominal voltage (V)	3
Nominal capacity (mAh)	0.8*
Continuous drain (mA)	0.005
Operating temperature (°C)	- 20 - + 60
Reflowable operating temperature (°C)	Max.230

\* Nominal capacity shown above is based on standard drain and cut off voltage down to 2.0V at 20

### Discharge characteristics

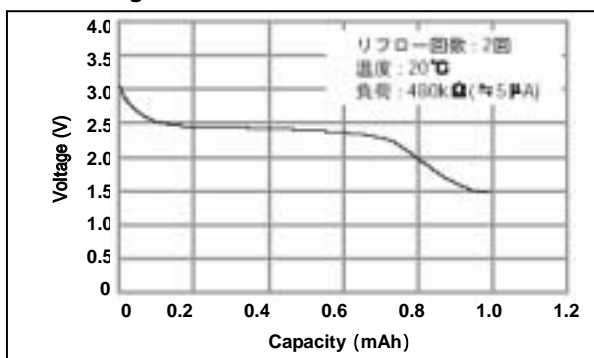

### Charge Voltage vs. Discharge capacity

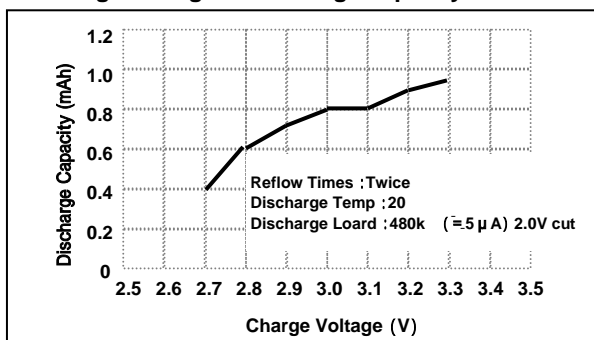

## ML414RH

### Dimensions (mm)

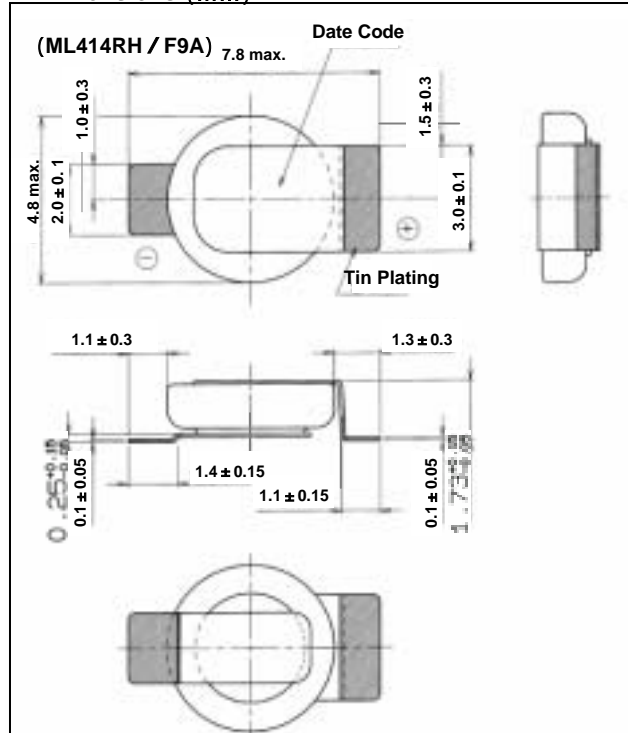

### Specification

Nominal voltage (V)	3
Nominal capacity (mAh)	1.0*
Continuous drain (mA)	0.005
Operating temperature (°C)	- 20 - + 60
Reflowable operating temperature (°C)	Max.260

\* Nominal capacity shown above is based on standard drain and cut off voltage down to 2.0V at 20

### Discharge characteristics

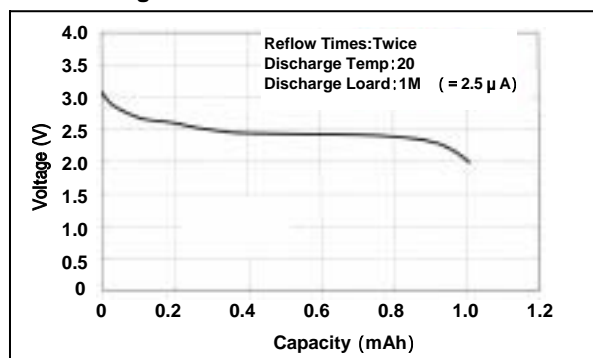

The data in this document are for descriptive purposes only and are not intended to make or imply any guarantee or warranty.